

S E R V I C E N O T E

SUPERSEDES

HP 3960 TAPE RECORDER

All Models Serial Prefix 1006 and Below

INSTALLATION OF NEW BRAKES

The 3960 brakes have been changed to improve overall performance. This change is classified as product improvement. However, in the event any part other than a brake band fails, the modification noted below must be incorporated.

Essentially the change does the following:

1. Changes the type of solenoid for more reliable operation at all Line Voltages from 105-125 (especially at low line).
2. In conjunction with above, the solenoid voltage source is changed from the plus (+) 24 volts to minus (-) 24 volts.
3. The brake tension springs are changed to increase the brake torque to the following:
 - a. Low direction 7-13 inch ounces
 - b. High direction 15-25 inch ounces

REQUIRED PARTS

<u>HP Part No.</u>	<u>Description</u>	<u>Qty Required</u>
0491-0054	Solenoid	1
1460-1207	Spring, Tension	2
1480-0084	Pin, Roll	1
2190-0003	Washer, Lock	1
2190-0418	Washer, Flat	1
2190-0434	Washer	2
2200-0141	Screw, Machine	1

BG/ps/WN

-continued-

8/71-42

HEWLETT PACKARD

For more information, call your local HP Sales Office or East (201) 265-5000 • Midwest (312) 677-0400 • South (404) 436-6101
West (213) 877-1282. Or, write: Hewlett-Packard, 1501 Page Mill Road, Palo Alto, California 94304. In Europe, 1217 Meyrin-Geneva

Printed in U.S.A.

HP Part No.	Description	Qty Required
03960-00970	Bracket, Mtg	1
03960-00980	Linkage, Solenoid	1
03960-00990	Linkage, Brake	1
03960-60600	Brake Band	2 (if require replacement)

INSTALLATION PROCEDURE

1. Remove any tape on recorder, set TAPE SPEED selector to medium speed, and disconnect power cable.
2. Place recorder face down on a cloth or cushion surface.
3. Remove three screws on each side of case and lift off case.
4. Remove two (2) chassis to deck screws on each side of chassis and swing away chassis.
5. Refer to 3960 Operating and Service Manual, Section 9, to gain access to brake assembly. Note: Ignore paragraph on brake band assemblies if brake bands to not require replacement.
6. Install new solenoid and brake linkage by reversing above procedure and referring to attached figures for proper sequence for assembly of the new brakes and linkage.
7. Adjust brakes per Section 6 of 3960 Operating and Service Manual.
8. Gain access to the switch assembly (A17). Refer to Section 9 of the 3960 Operating and Service Manual to gain access to switch assembly.
9. Remove the wire from the switch assembly (A17) Terminal G. Solder the end of the wire removed from A17 Terminal G to Pin 16 of K2 relay socket. It is necessary to pull the wire back through the chassis hole and harness until proper length to solder wire to Pin 16 of K2 relay socket.
10. Reassembly function switch assembly and recorder.
11. Check recorder per Section 5 of 3960 Operating and Service Manual.

-continued-

12. Change transport prefix to 1015A-XXXXX.
13. Make the following pen and ink changes to Section X, Figure 17 of 3960 Operating and Service Manual.

A. Change the following:

Figure & Index No.	Old Part No.	New Part No.	Desc.	Qty
17-51	03960-60910	0491-0054	Solenoid	1
17-53	2190-0006	2190-0434	Washer, Lock	2
17-55	03960-00010	03960-00970	Bracket, Mtg	1
17-59	03960-00090	03960-00990	Brake, Linkage	1
17-67	1460-0176	1460-1207	Spring, Tension	1
17-81	1460-0176	1460-1207	Spring, Tension	1

B. Delete the following:

Figure & Index No.	Part Number	Description
17-52	2360-0193	Screw, Machine
17-54	3050-0066	Washer, Flat

C. Add the following:

Figure & Index No.	Part Number	Description	Qty
17-52	1480-0084	Pin Roll	1
17-137	03960-00980	Linkage, Solenoid	1
17-138	2200-0141	Screw, Machine	1
17-139	2190-0003	Washer, Lock	1
17-140	2190-0418	Washer, Flat	1

- D. Add attached figures of this service note to Section X of 3960 Operating and Service Manual.

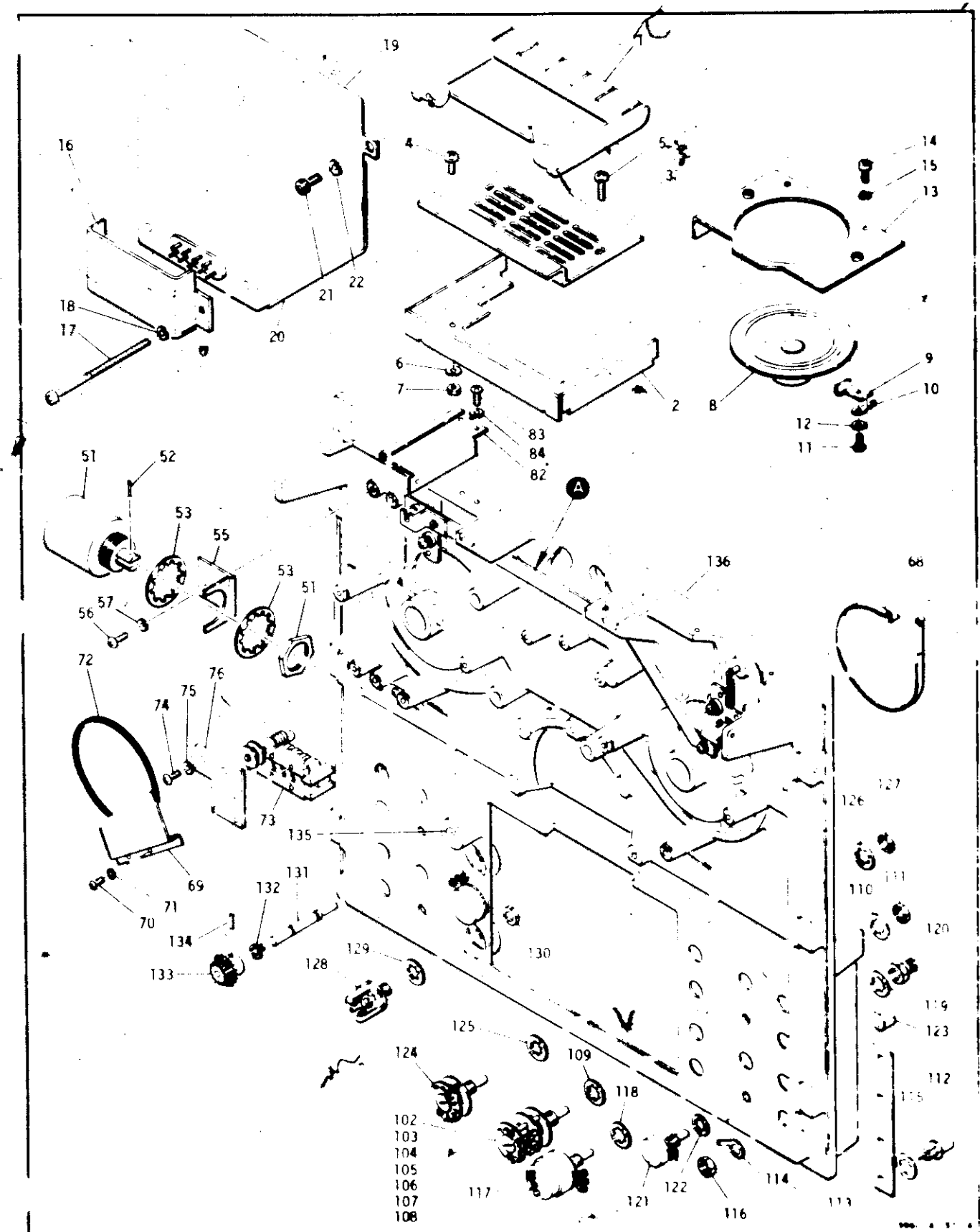
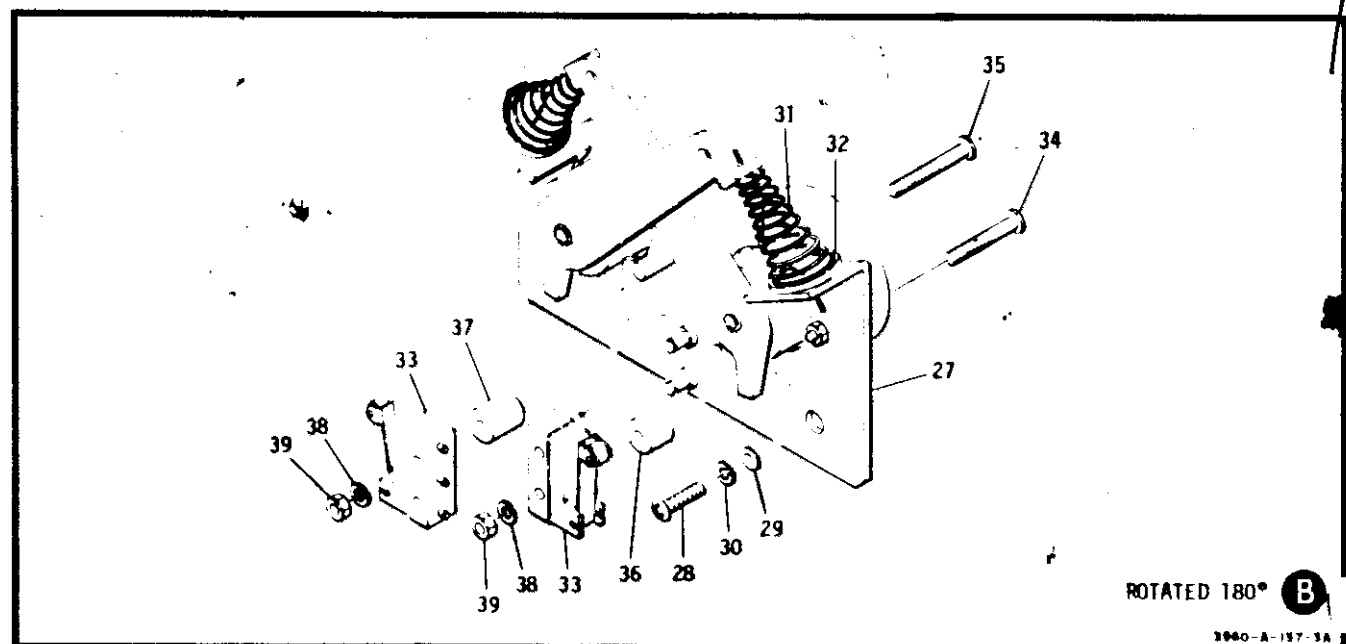
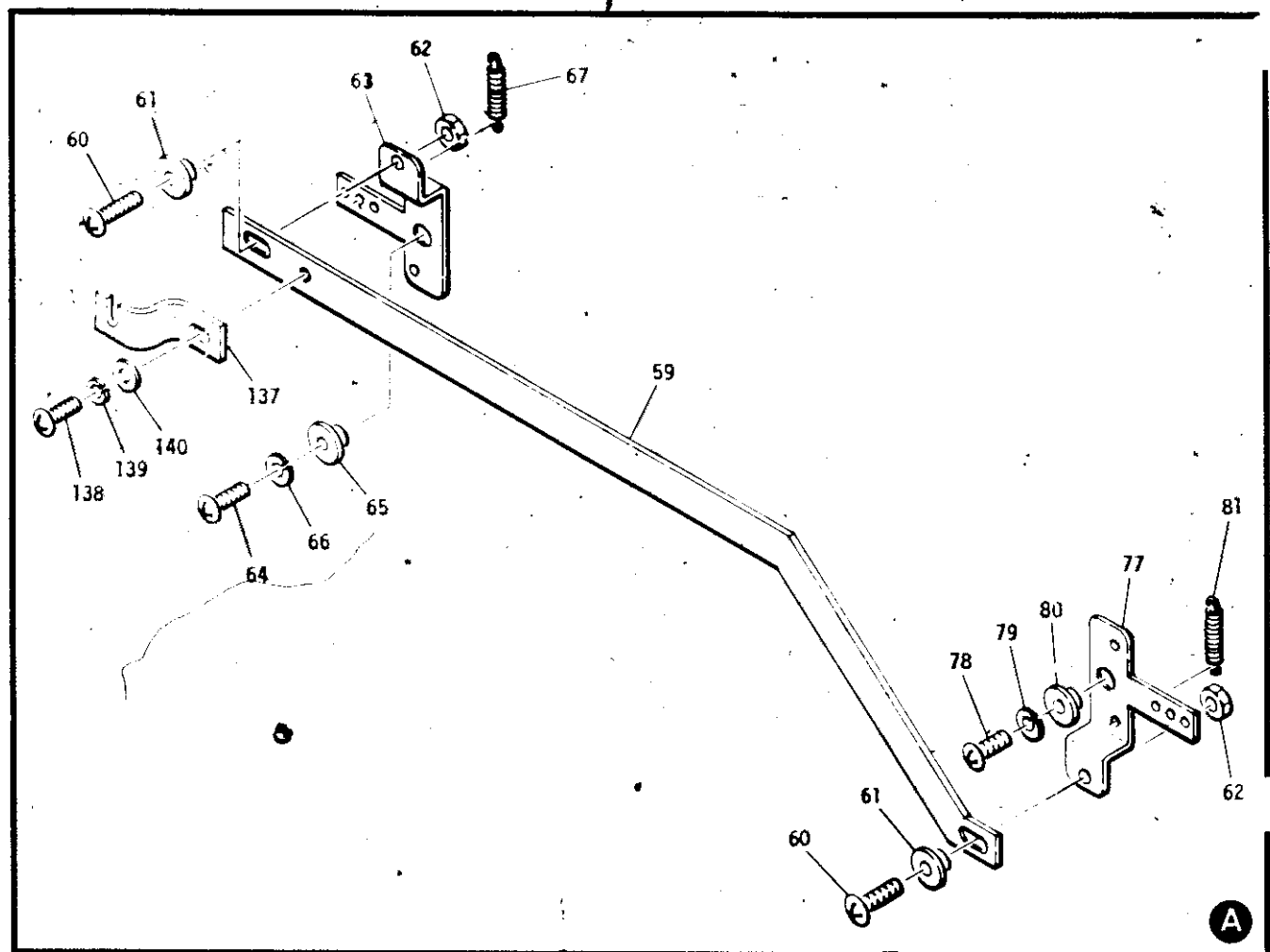

FIGURE 10-17 DECK CASTING ASSEMBLY (Sheet 1 of 3)



ROTATED 180° **B**

1940-A-157-3A

FIGURE 10-17 DECK CASTING ASSEMBLY (Sheet 3 of 3)