

# E5100A-33D

## S E R V I C E N O T E

Supersedes:  
E5100A-33C

### Agilent E5100A Network Analyzer

**Serial Numbers:** See Solution / Action

**Part number changes for color LCD and motherboard**

**Parts Required:**  
See Solution / Action

To Be Performed By: Agilent-Qualified Personnel

The change from E5100A-33B to E5100A-33C is as follows.

- Due to the old mother board assy (E5100-66520) discontinuance at the supplier, though only the old mother board needs to be repaired, LCD assy must be replaced for JP1KC00101 to JP5KC02919.

The change from E5100A-33B to E5100A-33C is as follows.

- Part number and qty-per correction for cushion of motherboard.

### ADMINISTRATIVE INFORMATION

SERVICE NOTE CLASSIFICATION:

**INFORMATION ONLY**

AUTHOR: jm      PRODUCT LINE: WN

ADDITIONAL INFORMATION:

© AGILENT TECHNOLOGIES, INC. 2007  
PRINTED IN U.S.A.



**Agilent Technologies**

April 20, 2007

**Situation:**

The color LCD used in the E5100A was obsoleted and replaced with a new color LCD. The old LCD is not available any more. When the LCD is defective, use new replacement LCD P/N 2090-0379 or LCD ASSY P/N E5100-65004. The new LCD has different assembly size from old one and is used with a new inverter board for backlight. Some other parts are additionally required for replacing the LCD depending on instrument serial number. (See service note E5100B-33B for the E5100B)

New motherboard is also set up for installation of the new LCD in the instrument. Unless the new LCD is combined with the correct motherboard, the instrument does not work normally (It can not respond to "BRIGHT OFF" command.)

**Solution/Action:**

When replacing the color LCD or motherboard assembly, use the appropriate replacement parts and assemblies for the instruments with serial numbers shown below:

**1.Parts required when replacing only Color LCD. ( See figures for the part level replacement procedure for the new color LCD assembly)**

Serial number	Part number	Qty	Description
JP1KC00101 to JP5KC02919	E5100-66521	1	NEW MOTHERBOARD ASSY
	0403-0424	7	CUSHION OF MOTHERBOARD
	E5100-65004*	1	E5100A/B COLOR LCD ASSY

\* See Note below.

JP5KC02920 to JP5KC03329 MY40500101 to MY40500121	E5100-65004 *	1	E5100A/B COLOR LCD ASSY
--	---------------	---	-------------------------

\* See Note below.

JP5KC03330 and Above MY40500122 and Above	2090-0379	1	COLOR LCD
--	-----------	---	-----------

\*Note: E5100-65004 is assembled from the following parts.

Part number	Qty	Description
2090-0379	1	COLOR LCD
E5000-04011	1	COVER LCD
E5000-61640	1	WIRE ASSY INVERTER
E5000-04002	1	COVER INVERTER
E5000-24004	2	STANDOFF
0950-3814	1	INVERTER BOARD
E5100-66570	1	LCD CABLE TRANSFER
8120-8409	1	RIBBON CABLE
1400-0611C	1	CLAMP CABLE
0515-1550	2	SCREW M3-L
0515-0922C	6	SCREW M2.5-L8
1400-1334	2	CLAMP CABLE
E5000-61660	1	FLAT CBL FFC
2190-0583	6	WASHER
0460-1029	1	TAPE-IDE 0.25IN

## 2. Parts required when replacing only motherboard assy

Serial number	Part number	Qty	Description
JP1KC00101 to JP5KC02919	E5100-66521	1	NEW MOTHERBOARD ASSY
	0403-0424	7	CUSHION OF MOTHERBOARD
	E5100-65004*	1	E5100A/B COLOR LCD ASSY

\* See Note of E5100-65004 above.

\*See service note E5100A-32 for MODIFICATION RECOMMENDED

JP5KC02920 to JP5KC03329	E5100-66521	1	NEW MOTHERBOARD ASSY
MY40500101 to MY40500121	0403-0424	7	CUSHION OF MOTHERBOARD
JP5KC03330 and Above	E5100-66521	1	NEW MOTHERBOARD ASSY
MY40500122 and Above	0403-0424	7	CUSHION OF MOTHERBOARD

## 3. E5100A/B COLOR LCD ASSY (E5100-65004) part:.

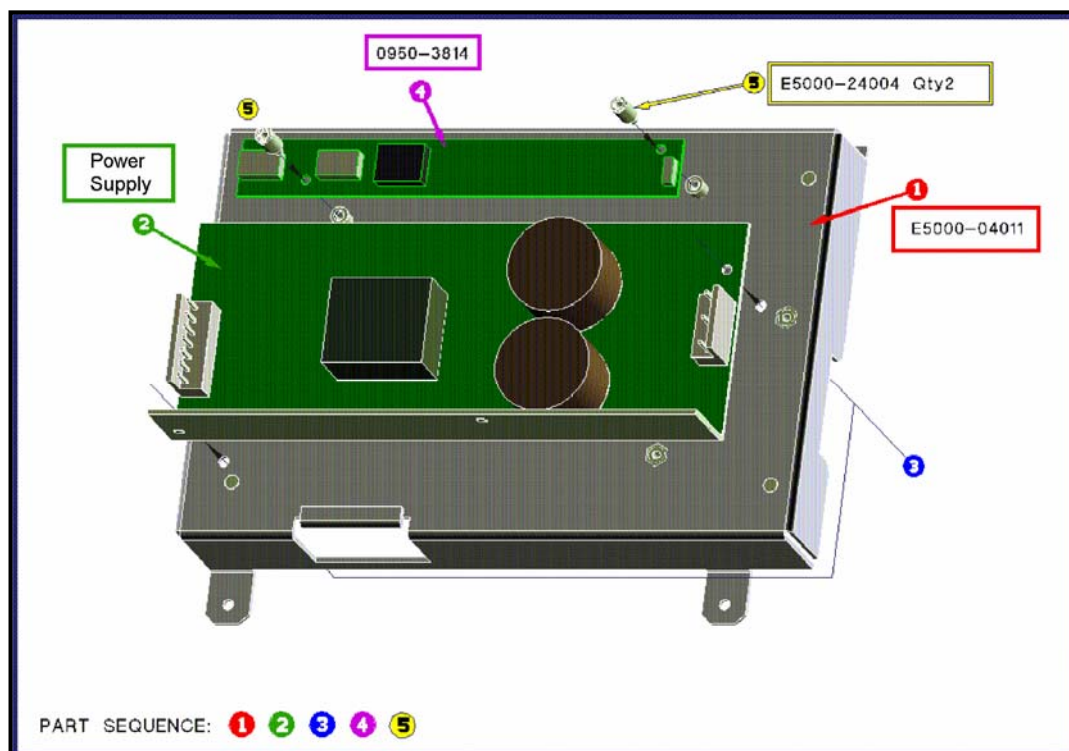

Ref Desig	Agilent Part Number	Qty	Description
1	E5000-04011	1	COVER LCD
4	0950-3814	1	INVERTER BOARD
5	E5000-24002	2	STANDOFF

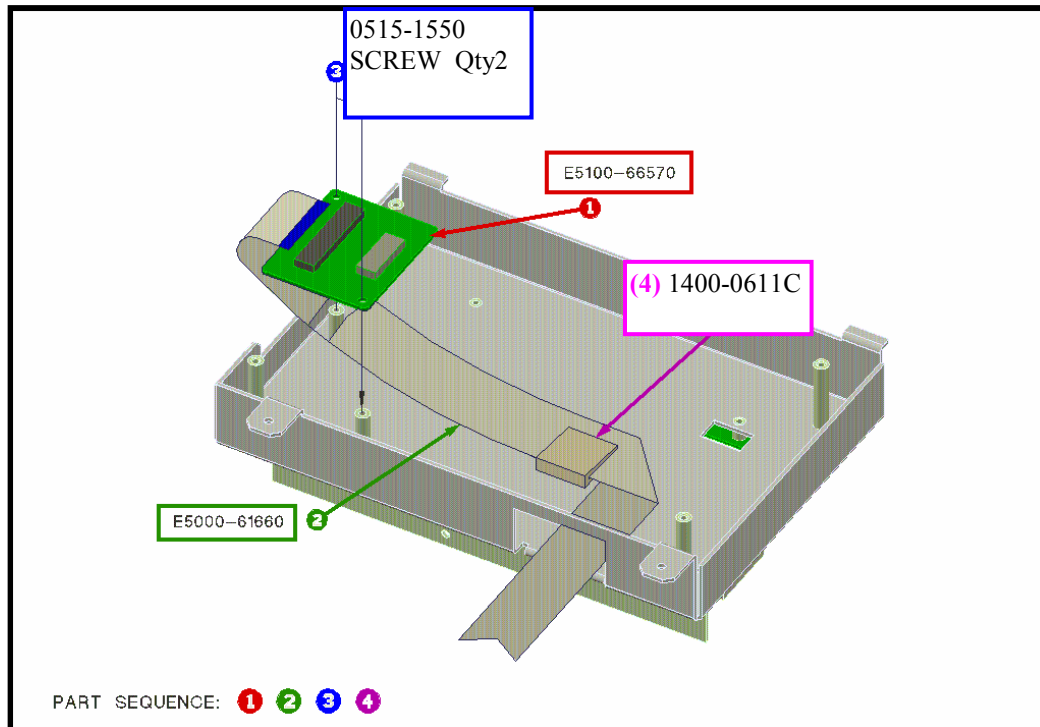

Ref Desig	Agilent Part Number	Qty	Description
1	E5100-66570	1	LCD CABLE TRANSFER
2	E5000-61660	1	FLAT CBL FCC
3	0515-1550	2	SCREW M3-L
4	1400-0611C	1	CLAMP CABLE

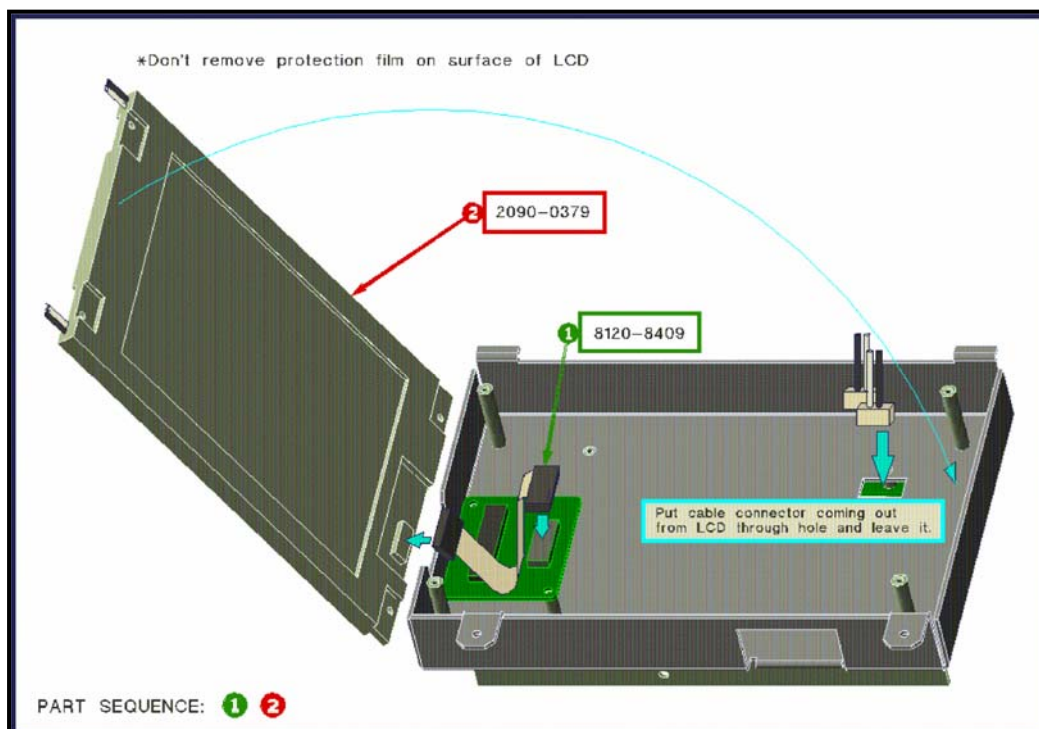

Ref Desig	Agilent Part Number	Qty	Description
1	8120-8409	1	RIBBON CABLE
2	2090-0379	1	COLOR LCD

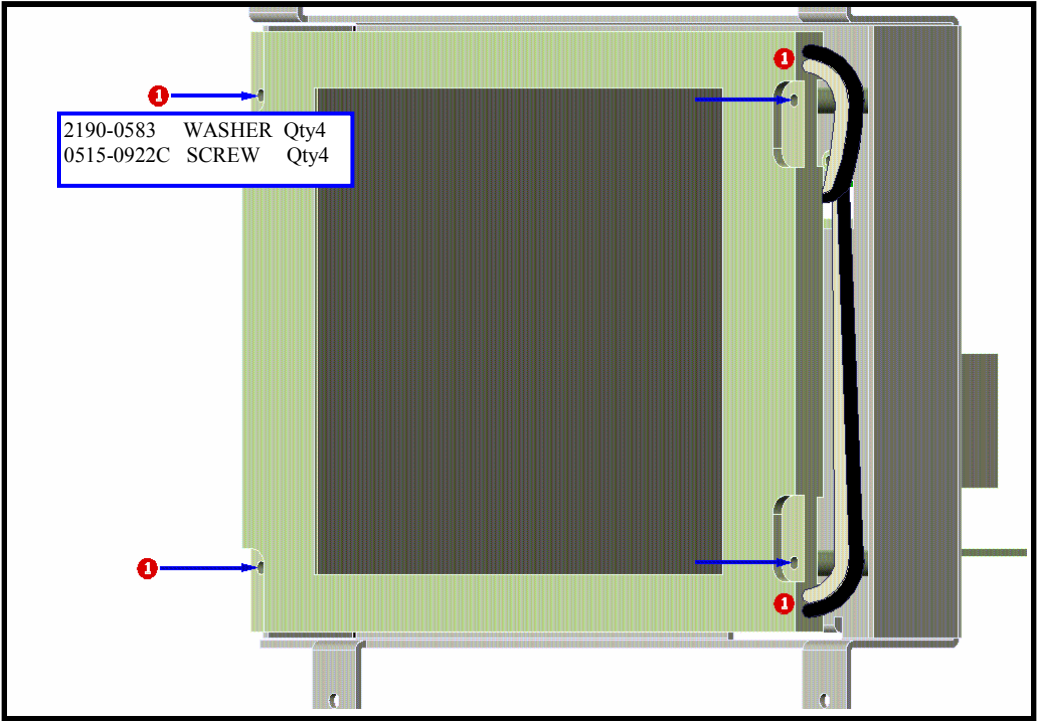

Ref Desig	Agilent Part Number	Qty	Description
1	2190-0583	4	WASHER
1	0515-0922C	4	SCREW M2.5-L8

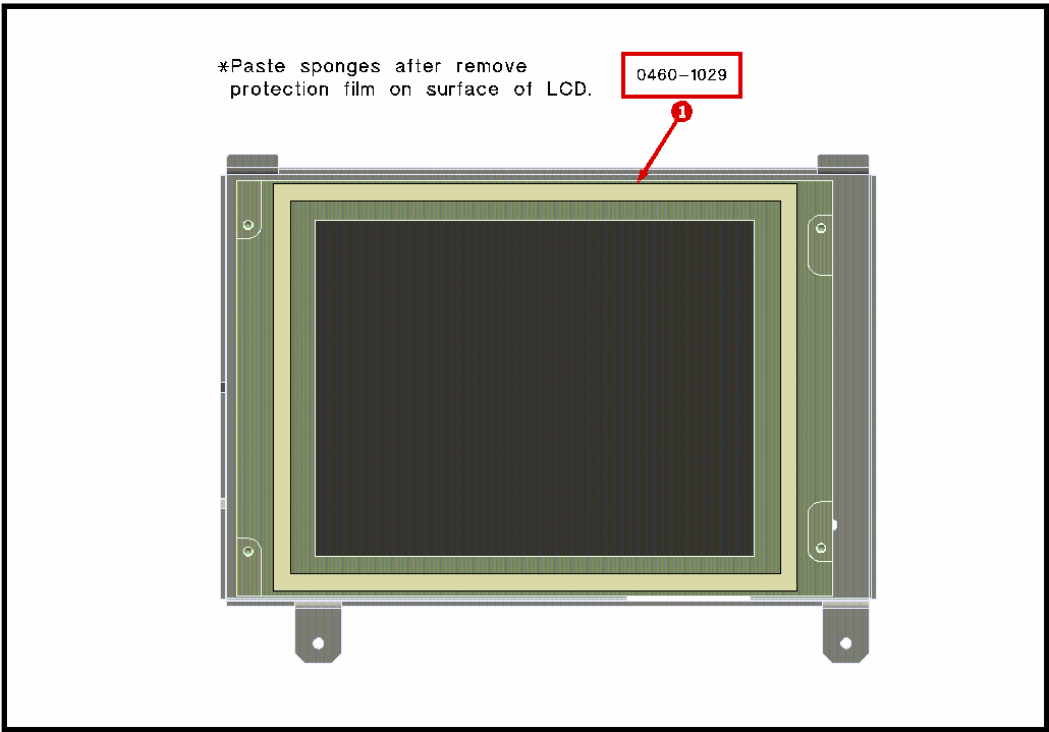

Ref Desig	Agilent Part Number	Qty	Description
1	0460-1029	1	TAPE-IDL 0.25IN



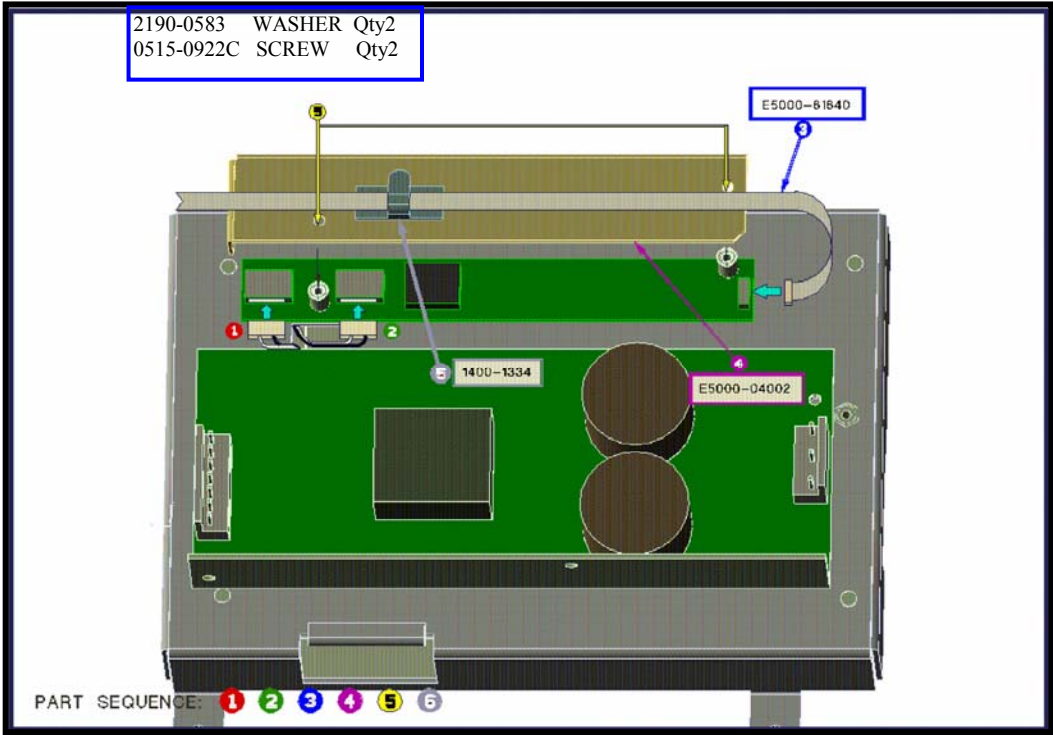

Ref Desig	Agilent Part Number	Qty	Description
3	E5000-61640	1	WIRE ASSY INVERTER
4	E5000-04002	1	COVER INVERTER
5	2190-0583	2	WASHER
5	0515-0922C	2	SCREW
6	1400-1334	1	CLAMP CABLE

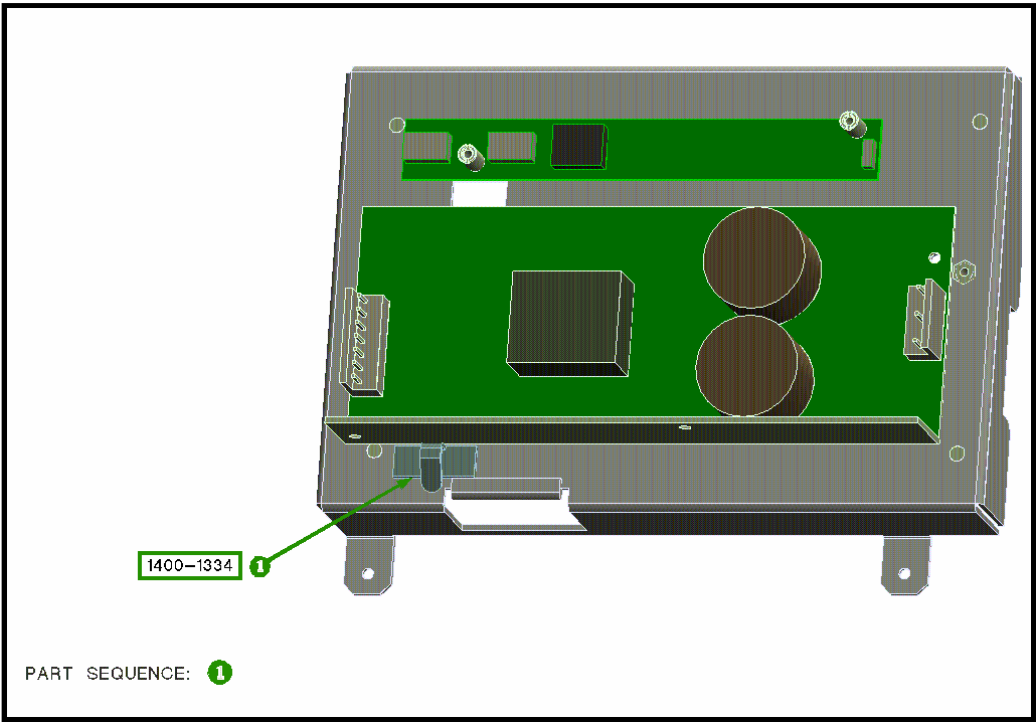

Ref Desig	Agilent Part Number	Qty	Description
1	1400-1334	1	CLAMP CABLE